



Safety is our first priority™

www.yoke.net

-- An ISO 9001 Certified Company --

YOKE INDUSTRIAL CORP.
#39, 33rd Road, Taichung Industrial Park,
Taichung 407, Taiwan
TEL:+886-4-2350-8088
FAX :+886-4-2350-1001
Email : info@mail.yoke.net

Shackle Safety Instruction

WARNING

- Loads may slip off or fall over if Shackle assembly and lifting process are not properly applied.
- A falling load may cause serious injury or death.
- Before installation and every use, visual inspection of YOKE SHACKLE should focus on any evidence of corrosion, wear, weld cracks and deformations.
- Use only YOKE parts as replacements.

Specification

YOKE 8-808, 8-807, 8-838, 8-837, 8-809, 8-805, 8-804, 8-835, 8-834

1. Safety Instruction

- **Screw Pin Shackles** are used for non-permanent applications. Screw pin Shackles can be used for side loading applications. Reduced working load limits are required for side-loading applications. While in service, do not allow the screw pin to be rotated by a live line, such as a choker application.
- **Bolt Pin Shackles** can be used in any application where screw pin Shackles are used. In addition, they are recommended for permanent or long-term installations and where the load may slide on the Shackle pin causing the pin to rotate. The bolt pin Shackle's secondary securement system, utilizing a nut and cotter, eliminates the requirement to tighten pin before each lift or movement of load.

2. Instruction manual

- Load only in the specified direction with WLL. The SHACKLE must be positioned to the load in such a way that movements are avoided during lifting.
 - a. The angle of loading shall not exceed 120 degree (Figure 1)
 - b. For side loading, the WLL of SHACKLE should reduce according to Table 1.



Safety is our first priority™

www.yoke.net

-- An ISO 9001 Certified Company --

YOKE INDUSTRIAL CORP.
#39, 33rd Road, Taichung Industrial Park,
Taichung 407, Taiwan
TEL:+886-4-2350-8088
FAX :+886-4-2350-1001
Email : info@mail.yoke.net

- **Temperature effects :**
Admissible operating temperature: -40° to 400° (please note WLL reduction at high temperature).
-40° to 200°C no reduction -40°F to 392°F
200° to 300°C minus 10 % 392°F to 572°F
300° to 400°C minus 25 % 572°F to 752°F
 - Do not use SHACKLE in connection with acids, bases or their vapor. For application in chemical environments, please contact our technical service.
 - Do not load SHACKLE when they are close to corners or sharp edges.
3. Maintenance, Checks, Repairs
- An inspection in accordance with the national standards must be carried out annually by a technical expert. If used frequently under a full load these inspections can be implemented regularly. Crack test is suggested every two years. The screw must be taken out from the body
 - The parts must be free from oil, dirt and rust for inspection and crack test. Cleaning procedures that overheat, hide failures on surface and cause hydrogen embrittlement or stress crack corrosion should not be carried out.
 - During inspection check all parts which can influence safety and function:
 - Cracks, notches, deformation, noticeable signs of excessive heat
 - Abrasion resp. corrosion of more than 10% of the cross section

In case of doubt, if the SHACKLE is damaged, stop using them and have them examined by an expert.



Safety is our first priority™

www.yoke.net

-- An ISO 9001 Certified Company --

YOKE INDUSTRIAL CORP.
#39, 33rd Road, Taichung Industrial Park,
Taichung 407, Taiwan
TEL:+886-4-2350-8088
FAX :+886-4-2350-1001
Email : info@mail.yoke.net

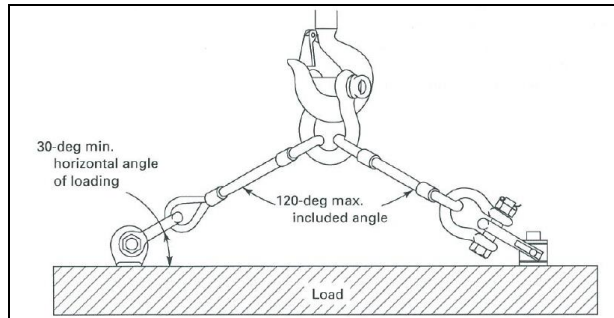

Figure 1

- The included angle between the slings should not exceed 120°

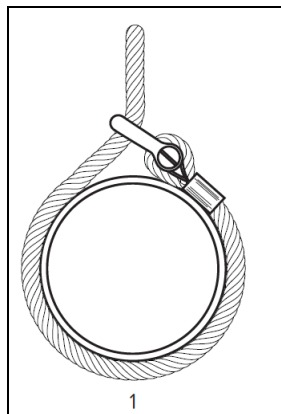

Figure 2

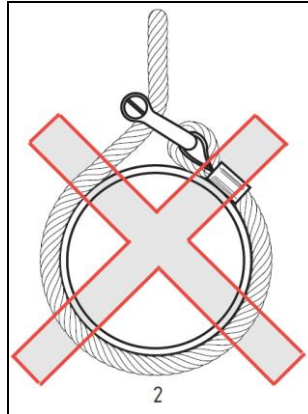

Figure 3

- Correct - Shackle pin cannot turn
- Incorrect - Shackle pin bearing on running line can work loose



Safety is our first priority™

www.yoke.net

-- An ISO 9001 Certified Company --

YOKE INDUSTRIAL CORP.
#39, 33rd Road, Taichung Industrial Park,
Taichung 407, Taiwan
TEL:+886-4-2350-8088
FAX :+886-4-2350-1001
Email : info@mail.yoke.net

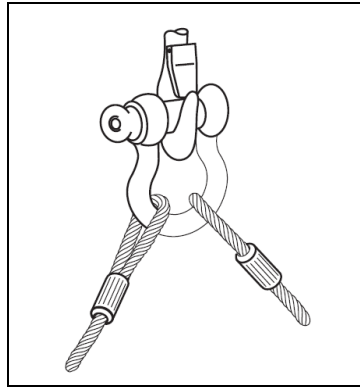

Figure 4

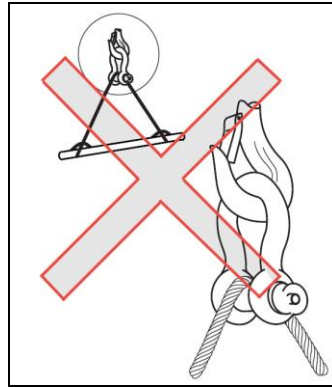

Figure 5

- Correct - use two ropes with eyes.
- Incorrect –the load is unstable and if the load shifts the sling will unscrew the Shackle pin

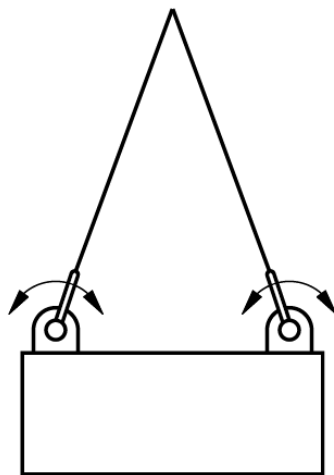

Figure 6

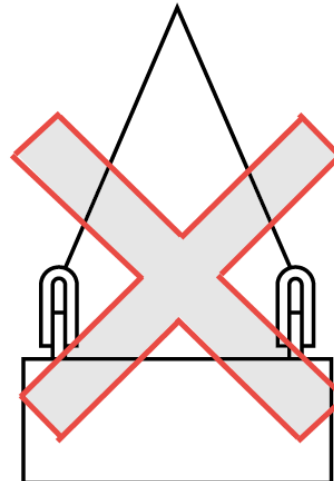

Figure 7

- In general this means that the Shackle body should take the load along the axis of its centreline.



Safety is our first priority™

www.yoke.net

-- An ISO 9001 Certified Company --

YOKE INDUSTRIAL CORP.
 #39, 33rd Road, Taichung Industrial Park,
 Taichung 407, Taiwan
 TEL:+886-4-2350-8088
 FAX :+886-4-2350-1001
 Email : info@mail.yoke.net

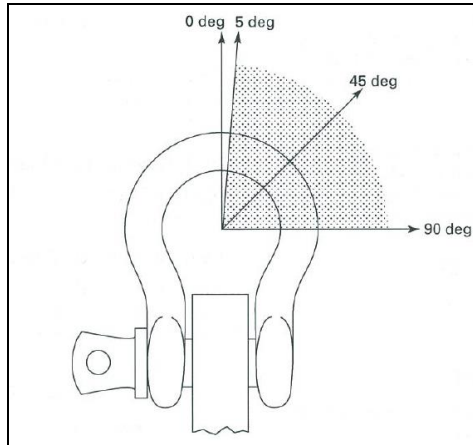

Figure 8

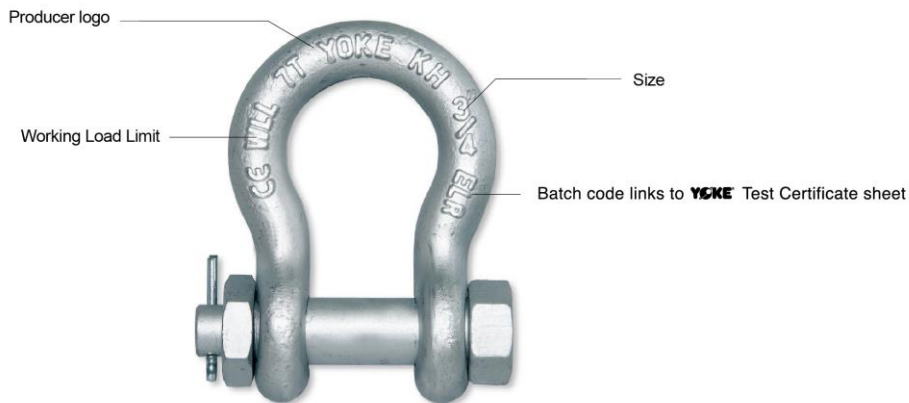

Figure 9

Side Loading Reduction Chart for Screw Pin and Bolt Type Shackle	
Angle of Side load from vertical In-Line of Shackle	Adjusted Working Load Limit
0° - 5° In-Line	100% of Rated Working Load Limit
45° from In-Line	70% of Rated Working Load Limit
90° from In-Line	50% of Rated Working Load Limit

Table 1 Side Loading Reduction



Safety is our first priority™

www.yoke.net

-- An ISO 9001 Certified Company --

YOKE INDUSTRIAL CORP.
 #39, 33rd Road, Taichung Industrial Park,
 Taichung 407, Taiwan
 TEL:+886-4-2350-8088
 FAX :+886-4-2350-1001
 Email : info@mail.yoke.net

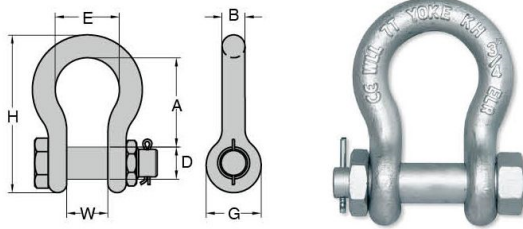

- Shackles are Type Approved by DNV & ABS.
- Shackles are forged alloy steel with alloy pin.
- Galvanized finish.

Type Approval



Forged Alloy Anchor Shackle

with Bolt Pin

Item No.	Nominal Size	Working Load Limit	Dimensions (inch)							N.W.
	inch		tonnes*	A	B	D	E	G	H	W
8-808-08	5/16	1.2	1.22	0.31	0.37	0.82	0.75	2.13	0.47	0.2
8-808-10	3/8	2	1.42	0.39	0.43	1.02	0.91	2.56	0.63	0.2
8-808-11	7/16	2.7	1.70	0.43	0.51	1.18	1.06	2.95	0.75	0.4
8-808-13	1/2	3.3	1.85	0.52	0.63	1.30	1.18	3.34	0.79	0.7
8-808-16	5/8	5	2.40	0.63	0.75	1.77	1.53	4.21	1.06	1.5
8-808-19	3/4	7	2.83	0.75	0.87	1.97	1.81	5.04	1.30	2.2
8-808-22	7/8	9.5	3.39	0.87	1.02	2.28	2.09	5.91	1.50	3.7
8-808-26	1	12.5	3.78	1.02	1.10	2.68	2.36	6.57	1.73	5.3
8-808-28	1 1/8	15	4.37	1.10	1.26	2.91	2.68	7.52	1.81	7.5
8-808-32	1 1/4	18	4.76	1.26	1.42	3.22	2.99	8.07	2.12	10.6
8-808-36	1 3/8	21	5.28	1.42	1.50	3.62	3.31	9.13	2.32	14.3
8-808-38	1 1/2	30	5.57	1.50	1.77	3.90	3.62	10.00	2.36	19.1
8-808-45	1 3/4	40	7.00	1.85	2.00	5.00	4.17	12.32	2.87	38.5
8-808-50	2	55	7.76	2.09	2.24	5.75	4.80	13.66	3.27	53.2

Item No.	Nominal Size	Working Load Limit	Dimensions (mm)							N.W.
	mm		tonnes*	A	B	D	E	G	H	W
8-808-08	8	1.2	31	8	9.5	21	19	54	13	0.1
8-808-10	10	2	36	10	11	26	23	65	16	0.1
8-808-11	11	2.7	43	11	13	30	27	75	19	0.2
8-808-13	13	3.3	47	13	16	33	30	85	20	0.3
8-808-16	16	5	61	16	19	43	39	107	27	0.7
8-808-19	19	7	72	19	22	50	46	126	33	1.0
8-808-22	22	9.5	86	22	26	58	53	148	38	1.7
8-808-26	26	12.5	96	26	28	68	60	166	44	2.4
8-808-28	28	15	111	28	32	74	68	190	46	3.4
8-808-32	32	18	121	32	36	82	76	210	54	4.8
8-808-36	36	21	134	36	38	92	84	232	59	6.5
8-808-38	38	30	146	38	45	99	92	254	60	8.7
8-808-45	45	40	178	47	51	127	106	313	73	17.5
8-808-50	50	55	197	53	57	146	122	347	83	24.2

★ Minimum Ultimate Load is 5 times the Working Load Limit.
 Maximum Proof Load is 2 times the Working Load Limit.



Safety is our first priority™

www.yoke.net

-- An ISO 9001 Certified Company --

YOKE INDUSTRIAL CORP.
 #39, 33rd Road, Taichung Industrial Park,
 Taichung 407, Taiwan
 TEL:+886-4-2350-8088
 FAX :+886-4-2350-1001
 Email : info@mail.yoke.net

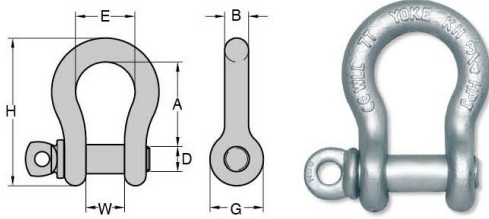

- Shackles are Type Approved by DNV & ABS.
- Shackles are forged alloy steel with alloy pin.
- Galvanized finish.

Type Approval



Forged Alloy Anchor shackle

with Screw Pin

Item No.	Nominal Size	Working Load Limit	Dimensions (inch)							N.W.
			A	B	D	E	G	H	W	
8-807-08	5/16	1.2	1.22	0.31	0.37	0.83	0.75	2.13	0.47	0.2
8-807-10	3/8	2	1.42	0.39	0.43	1.02	0.91	2.56	0.63	0.2
8-807-11	7/16	2.7	1.70	0.43	0.51	1.18	1.06	2.95	0.75	0.4
8-807-13	1/2	3.3	1.85	0.52	0.63	1.30	1.18	3.34	0.79	0.7
8-807-16	5/8	5	2.40	0.63	0.75	1.77	1.53	4.21	1.06	1.3
8-807-19	3/4	7	2.83	0.75	0.87	1.97	1.81	4.96	1.30	2.2
8-807-22	7/8	9.5	3.39	0.87	1.02	2.28	2.09	5.82	1.50	3.3
8-807-26	1	12.5	3.78	1.02	1.10	2.68	2.36	6.53	1.73	5.1
8-807-28	1 1/8	15	4.37	1.10	1.26	2.91	2.68	7.48	1.81	7.0
8-807-32	1 1/4	18	4.76	1.26	1.42	3.22	2.99	8.26	2.12	9.7
8-807-36	1 3/8	21	5.28	1.42	1.50	3.62	3.31	9.13	2.32	13.2

Item No.	Nominal Size	Working Load Limit	Dimensions (mm)							N.W.
			A	B	D	E	G	H	W	
8-807-08	8	1.2	31	8	9.5	21	19	54	12	0.1
8-807-10	10	2	36	10	11	26	23	65	16	0.1
8-807-11	11	2.7	43	11	13	30	27	75	19	0.2
8-807-13	13	3.3	47	13	16	33	30	85	20	0.3
8-807-16	16	5	61	16	19	43	39	107	27	0.6
8-807-19	19	7	72	19	22	50	46	126	33	1.0
8-807-22	22	9.5	86	22	26	58	53	148	38	1.5
8-807-26	26	12.5	96	26	28	68	60	166	44	2.3
8-807-28	28	15	111	28	32	74	68	190	46	3.2
8-807-32	32	18	121	32	36	84	76	210	54	4.4
8-807-36	36	21	134	36	38	92	84	232	59	6.0

★ Minimum Ultimate Load is 5 times the Working Load Limit.
 Maximum Proof Load is 2 times the Working Load Limit.



Safety is our first priority™

www.yoke.net

-- An ISO 9001 Certified Company --

YOKE INDUSTRIAL CORP.
 #39, 33rd Road, Taichung Industrial Park,
 Taichung 407, Taiwan
 TEL:+886-4-2350-8088
 FAX :+886-4-2350-1001
 Email : info@mail.yoke.net

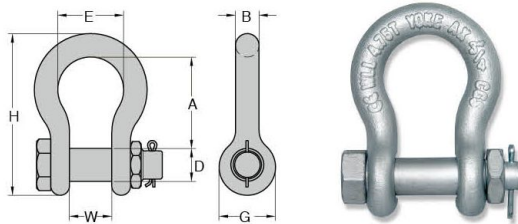

- Shackles are Type Approved by DNV & ABS.
- Shackles are forged carbon steel with alloy pin.
- Galvanized finish.

Type Approval



Forged Anchor Shackle

with Bolt Pin. Carbon Steel

Item No.	Nominal Size	Working Load Limit	Dimensions (inch)							N.W.
			inch	tonnes*	A	B	D	E	G	
8-838-08	5/16	0.75	1.22	0.31	0.37	0.82	0.75	2.13	0.47	0.2
8-838-10	3/8	1	1.42	0.39	0.43	1.02	0.91	2.56	0.63	0.2
8-838-11	7/16	1.5	1.70	0.43	0.51	1.18	1.06	2.95	0.75	0.4
8-838-13	1/2	2	1.85	0.52	0.63	1.30	1.18	3.34	0.79	0.9
8-838-16	5/8	3.25	2.40	0.63	0.75	1.70	1.50	4.17	1.06	1.5
8-838-19	3/4	4.75	2.83	0.75	0.87	1.97	1.81	5.04	1.30	2.2
8-838-22	7/8	6.5	3.39	0.87	1.02	2.28	2.09	5.91	1.50	3.7
8-838-26	1	8.5	3.78	1.02	1.10	2.68	2.40	6.57	1.73	5.3
8-838-28	1 1/8	9.5	4.37	1.10	1.26	2.91	2.68	7.52	1.81	7.5
8-838-32	1 1/4	12	4.76	1.26	1.42	3.30	2.99	8.07	2.12	10.6
8-838-36	1 3/8	13.5	5.28	1.42	1.50	3.62	3.31	9.13	2.32	14.3
8-838-38	1 1/2	17	5.57	1.50	1.77	3.90	3.62	10.00	2.36	19.4
8-838-45	1 3/4	25	7.00	1.85	2.00	5.00	4.17	12.32	2.87	38.5
8-838-50	2	35	7.76	2.09	2.24	5.75	4.80	13.66	3.27	53.2

Item No.	Nominal Size	Working Load Limit	Dimensions (mm)							N.W.
			mm	tonnes*	A	B	D	E	G	
8-838-08	8	0.75	31	8	9.5	21	19	54	12	0.1
8-838-10	10	1	36	10	11	26	23	65	16	0.1
8-838-11	11	1.5	43	11	13	30	27	75	19	0.2
8-838-13	13	2	47	13	16	33	30	85	20	0.4
8-838-16	16	3.25	61	16	19	43	38	106	27	0.7
8-838-19	19	4.75	72	19	22	50	46	126	33	1.0
8-838-22	22	6.5	86	22	26	58	53	148	38	1.7
8-838-26	26	8.5	96	26	28	68	61	166	44	2.4
8-838-28	28	9.5	111	28	32	74	68	190	46	3.4
8-838-32	32	12	121	32	36	84	76	210	54	4.8
8-838-36	36	13.5	134	36	38	92	84	232	59	6.5
8-838-38	38	17	146	38	45	99	92	254	60	8.8
8-838-45	45	25	178	47	51	127	106	313	73	17.5
8-838-50	50	35	197	53	57	146	122	347	83	24.2

★ Minimum Ultimate Load is 6 times the Working Load Limit.
 Maximum Proof Load is 2 times the Working Load Limit.



Safety is our first priority™

www.yoke.net

-- An ISO 9001 Certified Company --

YOKE INDUSTRIAL CORP.
 #39, 33rd Road, Taichung Industrial Park,
 Taichung 407, Taiwan
 TEL:+886-4-2350-8088
 FAX :+886-4-2350-1001
 Email : info@mail.yoke.net

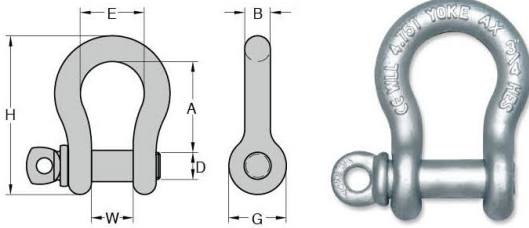

- Shackles are Type Approved by DNV & ABS.
- Shackles are forged carbon steel with alloy pin.
- Galvanized finish.

Type Approval



Forged Anchor Shackle

with Screw Pin. Carbon Steel

Item No.	Nominal Size	Working Load Limit	Dimensions (inch)							N.W.
	inch		tonnes*	A	B	D	E	G	H	W
8-837-05	3/16	0.3	0.87	0.2	0.25	0.69	0.57	1.48	0.38	0.05
8-837-06	1/4	0.5	1.10	0.26	0.32	0.80	0.63	1.85	0.47	0.1
8-837-08	5/16	0.75	1.22	0.31	0.37	0.82	0.75	2.13	0.47	0.2
8-837-10	3/8	1	1.42	0.39	0.43	1.02	0.91	2.56	0.63	0.2
8-837-11	7/16	1.5	1.70	0.43	0.51	1.18	1.06	2.95	0.75	0.4
8-837-13	1/2	2	1.85	0.52	0.63	1.30	1.18	3.34	0.79	0.7
8-837-16	5/8	3.25	2.40	0.63	0.75	1.70	1.50	4.17	1.06	1.3
8-837-19	3/4	4.75	2.83	0.75	0.87	1.96	1.81	5.04	1.30	2.2
8-837-22	7/8	6.5	3.39	0.87	1.02	2.28	2.08	5.91	1.50	3.3
8-837-26	1	8.5	3.78	1.02	1.10	2.68	2.67	6.57	1.73	5.1
8-837-28	1 1/8	9.5	4.37	1.10	1.26	2.91	2.68	7.52	1.81	7.0
8-837-32	1 1/4	12	4.76	1.26	1.42	3.30	2.99	8.07	2.12	9.9
8-837-36	1 3/8	13.5	5.28	1.42	1.50	3.62	3.30	9.13	2.32	13.9
8-837-38	1 1/2	17	5.75	1.50	1.77	3.90	3.62	10.00	2.36	17.8
8-837-45	1 3/4	25	7.00	1.85	2.00	5.00	4.17	12.32	2.87	35.9
8-837-50	2	35	7.76	2.09	2.24	5.75	4.80	13.66	3.27	51.0

Item No.	Nominal Size	Working Load Limit	Dimensions (mm)							N.W.
	mm		tonnes*	A	B	D	E	G	H	W
8-837-05	5	0.3	22	5	6	17	15	38	10	0.021
8-837-06	6	0.5	28	6.5	8	20	16	47	12	0.05
8-837-08	8	0.75	31	8	9.5	21	19	54	12	0.1
8-837-10	10	1	36	10	11	26	23	65	16	0.1
8-837-11	11	1.5	43	11	13	30	27	75	19	0.2
8-837-13	13	2	47	13	16	33	30	85	20	0.3
8-837-16	16	3.25	61	16	19	43	38	106	27	0.6
8-837-19	19	4.75	72	19	22	50	46	126	33	1.0
8-837-22	22	6.5	86	22	26	58	53	148	38	1.5
8-837-26	26	8.5	96	26	28	69	61	166	44	2.3
8-837-28	28	9.5	111	28	32	74	68	190	46	3.2
8-837-32	32	12	121	32	36	84	76	210	54	4.5
8-837-36	36	13.5	134	36	38	92	84	232	59	6.3
8-837-38	38	17	146	38	45	99	92	254	60	8.1
8-837-45	45	25	178	47	51	127	106	313	73	16.3
8-837-50	50	35	197	53	57	146	122	347	83	23.2

★ Minimum Ultimate Load is 6 times the Working Load Limit.
 Maximum Proof Load is 2 times the Working Load Limit.



Safety is our first priority™

www.yoke.net

-- An ISO 9001 Certified Company --

YOKE INDUSTRIAL CORP.
 #39, 33rd Road, Taichung Industrial Park,
 Taichung 407, Taiwan
 TEL:+886-4-2350-8088
 FAX :+886-4-2350-1001
 Email : info@mail.yoke.net

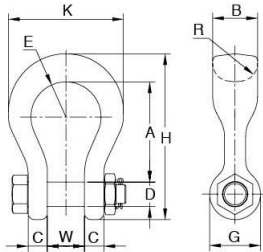

Fig. 1

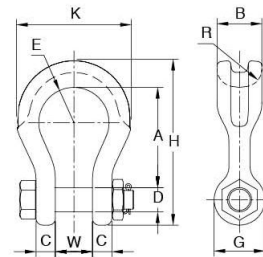

Fig. 2



- Shackles are forged alloy steel with alloy pin.
- Galvanized finish.

Forged Alloy Wide Body Shackle

with Bolt Pin

Item No.	Nominal Size	Working Load Limit	Dimensions (inch)										N.W.
			inch	tonnes*	A	B	C	D	E	G	H	K	
8-809-19	3/4	7	3.58	1.61	0.70	0.87	1.26	1.81	5.90	4.09	1.26	1.30	3.7
8-809-26	1	12.5	4.64	2.12	0.91	1.14	1.61	2.40	7.64	5.51	1.38	1.73	8.4
8-809-32	1 1/4	18	5.83	2.52	1.18	1.42	2.00	2.68	9.37	6.77	1.50	2.13	14.7
8-809-38	1 1/2	30	6.93	3.15	1.38	1.77	2.50	3.50	11.38	8.50	1.77	2.36	27.5

★ Minimum Ultimate Load is 5 times the Working Load Limit.
 Maximum Proof Load is 2 times the Working Load Limit.

★ 8-809-19/-26 See Figure 1

★ 8-809-32/-38 See Figure 2

Item No.	Nominal Size	Working Load Limit	Dimensions (mm)										N.W.
			mm	tonnes*	A	B	C	D	E	G	H	K	
8-809-19	19	7	91	41	18	22	32	46	150	104	32	33	1.7
8-809-26	26	12.5	118	54	23	29	41	61	194	140	35	44	3.8
8-809-32	32	18	148	64	30	36	51	68	238	172	38	54	6.7
8-809-38	38	30	176	80	35	45	64	89	289	216	45	60	12.5

★ Minimum Ultimate Load is 5 times the Working Load Limit.
 Maximum Proof Load is 2 times the Working Load Limit.



Safety is our first priority™

www.yoke.net

-- An ISO 9001 Certified Company --

YOKE INDUSTRIAL CORP.
 #39, 33rd Road, Taichung Industrial Park,
 Taichung 407, Taiwan
 TEL:+886-4-2350-8088
 FAX :+886-4-2350-1001
 Email : info@mail.yoke.net



Forged Alloy Chain Shackle

with Bolt Pin

- Shackles are Type Approved by ABS.
- Shackles are forged alloy steel with alloy pin.
- Galvanized finish.

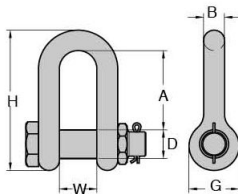

Item No.	Nominal Size	Working Load Limit tonnes*	Dimensions (mm)						N.W. kg
	inch		A	B	D	G	H	W	
8-805-16	5/8	5	60	16	19	38	106	27	0.6
8-805-19	3/4	7	71	19	22	46	126	33	1.0
8-805-22	7/8	9.5	87	22	26	53	148	38	1.6
8-805-26	1	12.5	95	26	28	60	166	44	2.4
8-805-28	1 1/8	15	108	28	32	68	190	46	3.3
8-805-32	1 1/4	18	119	32	36	76	210	52	4.6
8-805-36	1 3/8	21	133	36	38	84	232	57	6.2

Type Approval



Type Approval

★ Minimum Ultimate Load is 5 times the Working Load Limit.
 Maximum Proof Load is 2 times the Working Load Limit.



Forged Alloy Chain Shackle

with Screw Pin

- Shackles are Type Approved by DNV & ABS.
- Shackles are forged alloy steel with alloy pin.
- Galvanized finish.

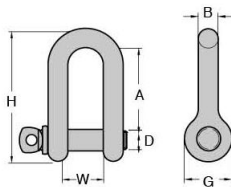

Item No.	Nominal Size	Working Load Limit tonnes*	Dimensions (mm)						N.W. kg
	inch		A	B	D	G	H	W	
8-804-08	5/16	1.2	31	8	9.5	19	52	13	0.1
8-804-10	3/8	2	36	10	11	23	63	16	0.1
8-804-11	7/16	2.7	43	11	13	27	74	19	0.2
8-804-13	1/2	3.3	47	13	16	30	83	20	0.3
8-804-16	5/8	5	60	16	19	38	106	27	0.6
8-804-19	3/4	7	71	19	22	46	126	33	0.9
8-804-22	7/8	9.5	87	22	26	53	148	38	1.4
8-804-26	1	12.5	95	26	28	60	166	44	2.2
8-804-28	1 1/8	15	108	28	32	68	190	46	3.0
8-804-32	1 1/4	18	119	32	36	76	210	52	4.2
8-804-36	1 3/8	21	133	36	38	84	232	57	5.7

Type Approval



Type Approval

★ Minimum Ultimate Load is 5 times the Working Load Limit.
 Maximum Proof Load is 2 times the Working Load Limit.



Safety is our first priority™

www.yoke.net

-- An ISO 9001 Certified Company --

YOKE INDUSTRIAL CORP.
 #39, 33rd Road, Taichung Industrial Park,
 Taichung 407, Taiwan
 TEL:+886-4-2350-8088
 FAX :+886-4-2350-1001
 Email : info@mail.yoke.net



Forged Chain Shackle

with Bolt Pin

- Shackles are Type Approved by ABS.
- Shackles are forged carbon steel with alloy pin.
- Galvanized finish.

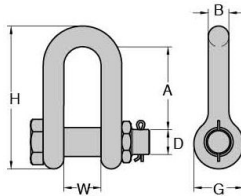

Item No.	Nominal Size	Working Load Limit tonnes*	Dimensions (mm)						N.W.
	inch		A	B	D	G	H	W	kg
8-835-08	5/16	0.75	31	8	9.5	19	52	13	0.1
8-835-10	3/8	1	36	10	11	23	63	16	0.1
8-835-11	7/16	1.5	43	11	13	27	74	19	0.2
8-835-13	1/2	2	57	13	16	30	83	20	0.3
8-835-16	5/8	3.25	60	16	19	38	106	27	0.6
8-835-19	3/4	4.75	71	19	22	46	126	33	1.0
8-835-22	7/8	6.5	87	22	26	53	148	38	1.6
8-835-26	1	8.5	95	26	28	60	166	44	2.4
8-835-28	1 1/8	9.5	108	28	32	68	190	46	3.2
8-835-32	1 1/4	12	119	32	36	76	210	52	4.5
8-835-36	1 3/8	13.5	133	36	38	84	232	57	6.1

Type Approval



★ Minimum Ultimate Load is 6 times the Working Load Limit.
 Maximum Proof Load is 2 times the Working Load Limit.



Forged Chain Shackle

with Screw Pin

- Shackles are Type Approved by ABS.
- Shackles are forged carbon steel with alloy pin.
- Galvanized finish.

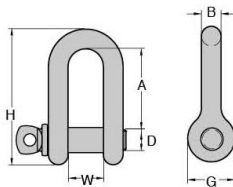

Item No.	Nominal Size	Working Load Limit tonnes*	Dimensions (mm)						N.W.
	inch		A	B	D	G	H	W	kg
8-834-08	5/16	0.75	31	8	9.5	19	52	13	0.1
8-834-10	3/8	1	36	10	11	23	63	16	0.1
8-834-11	7/16	1.5	43	11	13	27	74	19	0.2
8-834-13	1/2	2	57	13	16	30	83	20	0.3
8-834-16	5/8	3.25	60	16	19	38	106	27	0.6
8-834-19	3/4	4.75	71	19	22	46	126	33	1.0
8-834-22	7/8	6.5	87	22	26	53	148	38	1.5
8-834-26	1	8.5	95	26	28	60	166	44	2.2
8-834-28	1 1/8	9.5	108	28	32	68	190	46	3.0
8-834-32	1 1/4	12	119	32	36	76	210	52	4.2
8-834-36	1 3/8	13.5	133	36	38	84	232	57	5.7

Type Approval



★ Minimum Ultimate Load is 6 times the Working Load Limit.
 Maximum Proof Load is 2 times the Working Load Limit.